

Flexible Duct DFM

SPIRO DUCT + FITTINGS + GRILLES + DIFFUSERS + FILTERS + FLEXIBLE DUCT + ACCESORIES

Flexible duct with R 4.2, R6 , R8 fiberglass insulation double metallized polyester film jacket as a vapor barrier (against condensation) and an interior duct of double metallized polyester film, reinforced by tempered steel spring. Available in 25 FT. long.

1 Prinicpal Features

- Higher thickness of the polyester films (higher resistance)
- Ducts from 4" to 10" in 1" increments and 12" - 20" in 2" increments with a higher thickness wire for reinforcement.
- Metallic ducts (interior and exterior).
- Self-extinguishing polyester films and low smoke and flame.
- Higher tempered wire gauge.
- Impermeable packaging and less volume.
- 1 year warrant against defects in materials and workmanship

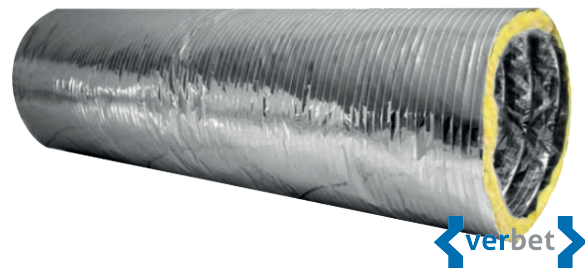

OWENS CORNING FIBERGLASS
QUALITY and specifications by OWENS CORNING

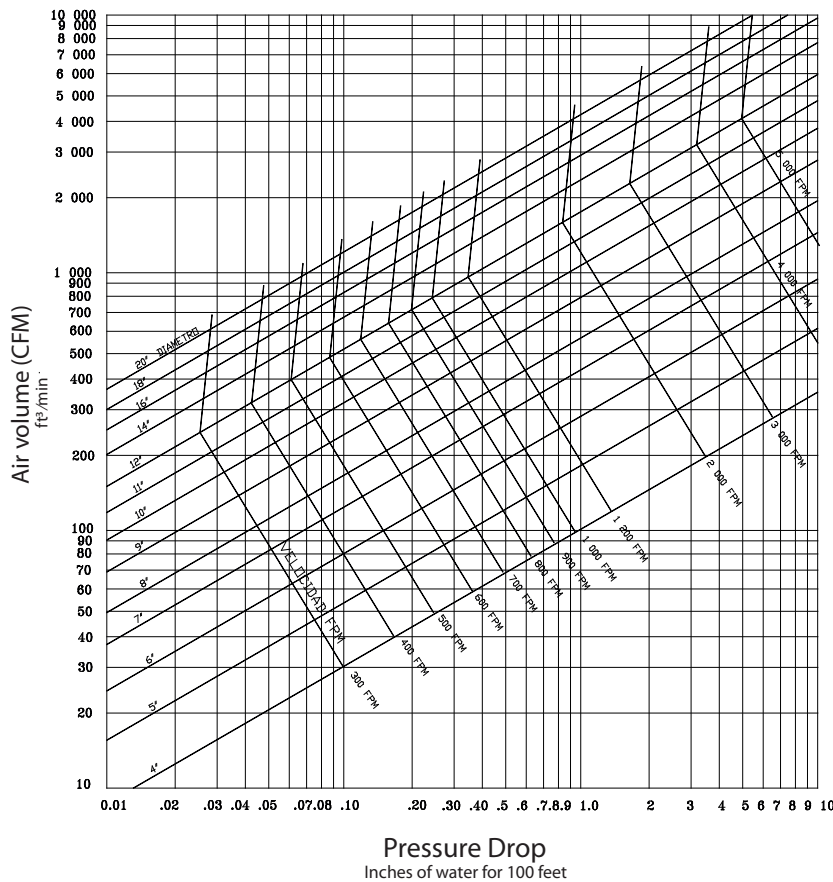

Flexible Duct DFM

SPIRO DUCT + FITTINGS + GRILLES + DIFFUSERS + FILTERS + FLEXIBLE DUCT + ACCESORIES

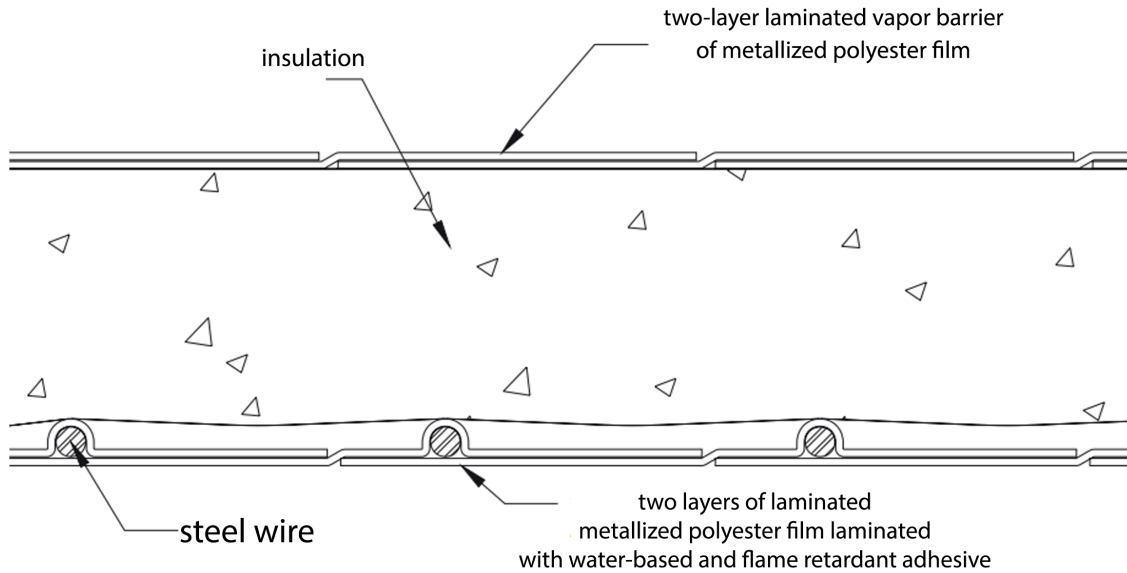

Characteristics	Advantages
Polyester films	Thicker, more resistant. Self-extinguishing and low smoke and flame emission.
wire	High carbon alloy 1-3/4" wire spacing in all diameters
Thermoacoustic insulation	R=R4.2, R6, R8 of owens corning with owens corning RF-3075 quality and specifications, ISO-9002 process.
Adhesive	water-based acrylic with flame retardant
Construction	interior and exterior ducts with double metallized polyester film
Size	Core diameter Diameters from 4" - 10" in 1" intervals and 12" - 20" in 2" intervals
packing	waterproof smallest volume in box
warehouse	consistent in all sizes for immediate delivery
warranty	for 1 year for defects in materials and workmanship

Flexible Duct DFM

SPIRO DUCT + FITTINGS + GRILLES + DIFFUSERS + FILTERS + FLEXIBLE DUCT + ACCESORIES

INSTALLATION INSTRUCTIONS Air Ducts And Air Connectors Nonmetallic with Plain Ends

Application

Air ducts and air connectors may be connected to a round sheet metal fitting (collar, pipe coupling, etc.) Or spliced to any other duct of a corresponding nominal size.

Procedure

1. Select and use appropriate tools/materials listed below.
2. Follow "Precautions" listed below.
3. Refer to installations guidelines on this package.

Tools and accessory material required

1. Knife or scissors/wire cutter: Use knife or scissors to cut duct wall. Use wire cutters to cut spiral wire helix.
2. Duct tape: Use only tapes that have been listed and labeled to standard UL 181B and marked "181B-FX" Use two wraps of 1-7/8 inch minimum width.
3. Metal clamp/screw driver: Use for low, medium or high pressure system up to 10 inch w.g.

Precautions:

- * Do not use "outdoors" or install where duct can be exposed to sunlight. Prolonged exposure may cause degradation of vapor barrier.
- * Do not install where duct can be exposed to UV radiation from bio-treatment lamps within the HVAC system. Exposure may cause degradation of the inner core.
- * Do not exceed published pressure or temperature limits.
- * Do not use duct to hang or support any diffuser, register or other equipment during installation.
- * Do not use screws or barbed fitting to make connections on ducts with plain ends.
- * Duct should be supported at 5' maximum intervals unless resting on ceiling joists or truss support.
- * Do not use on oval collars for medium or high pressure.
- * Use the appropriate tightening tool per the fastener manufacturer's instructions.

